



**BUILD**  
Building Solutions

**BUILD**<sup>TM</sup>  
Building Solutions

STRONGER • SMARTER • FASTER  
**MORE AFFORDABLE**

**KIT HOMES**

**OAKDALE**

Boasting a generously sized living room that provides ample space for relaxation and entertainment, as well as a charming outdoor deck that extends the living space to the great outdoors, the Oakdale is the epitome of small and compact living done right. This cozy yet functional addition to your property is designed to make the most of every square inch, offering a perfect blend of comfort and versatility.

ENCLOSED	OTHER
17.22m <sup>2</sup>	3.20m <sup>2</sup>
<b>TOTAL 20.42m<sup>2</sup></b>	
1-	1
	1



59<sup>TH</sup> AUSTRALIAN  
Export & Investment Awards

INTERNATIONAL  
EXPORT  
AWARDS  
2021

1800 679 268  
info@i-build.com.au  
www.i-build.com.au

Facebook@ibuildau  
YouTube@ibuildbuilding  
Pinterest@ibuildbuildings

Eastern Innovation  
5A Hartnett Close  
Mulgrave VIC 3170

© copyright iBuild - v9.17 20220930

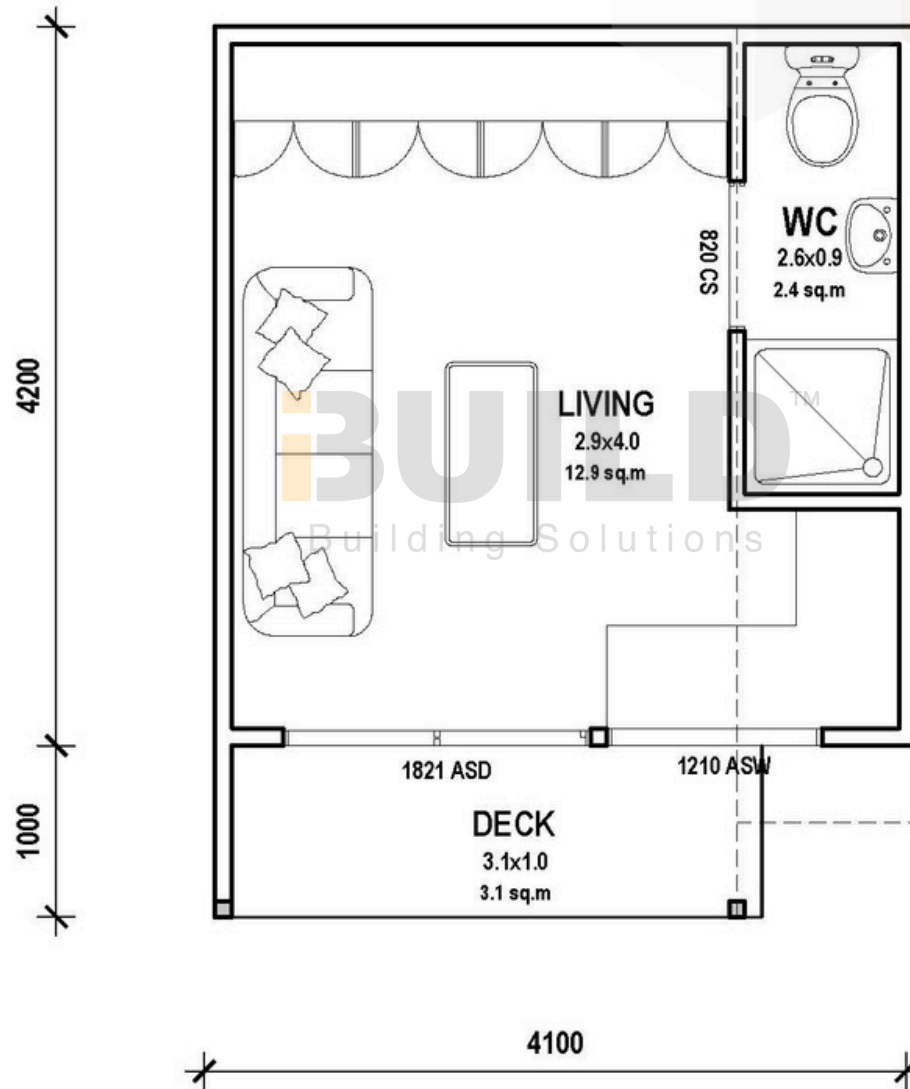

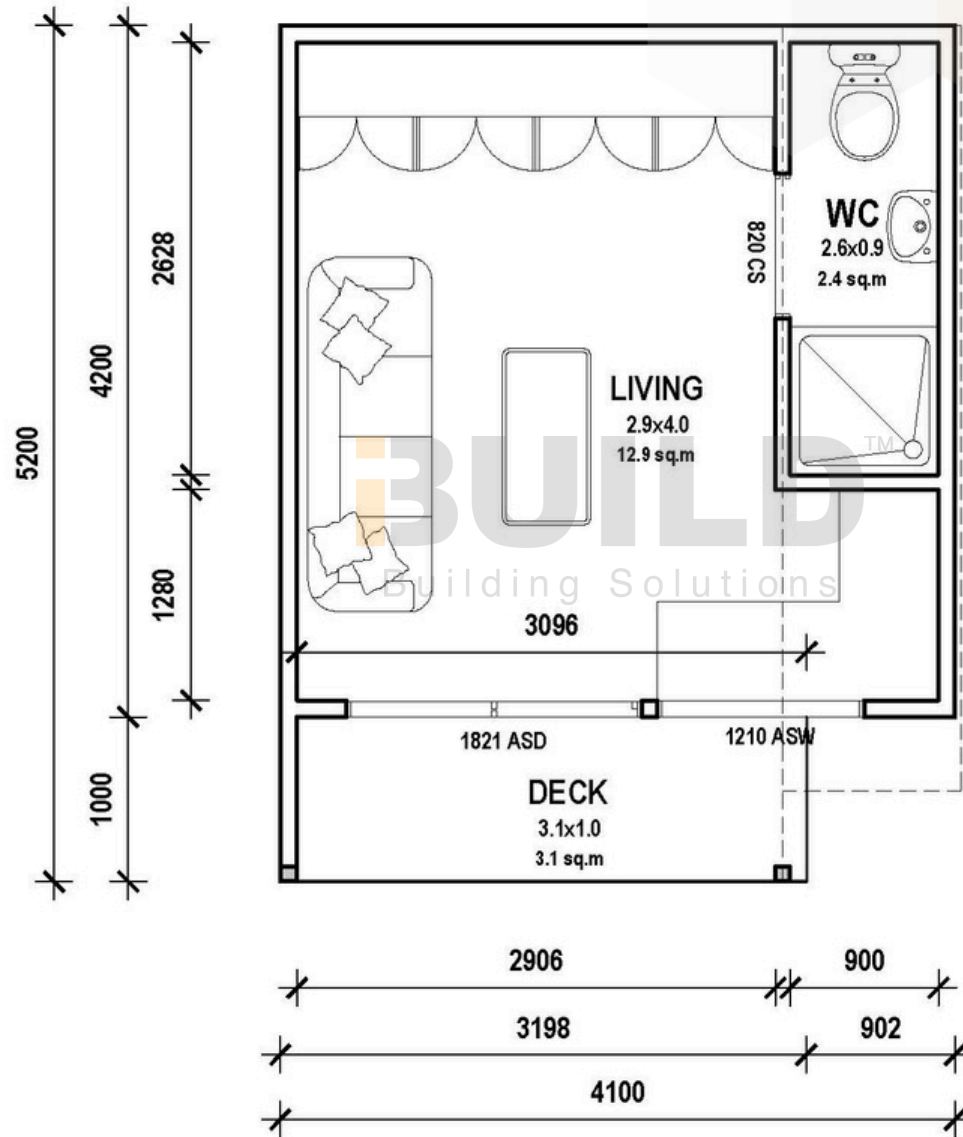



**BUILD**<sup>TM</sup>  
Building Solutions