



KIT HOMES

OAKDALE

Boasting a generously sized living room that provides ample space for relaxation and entertainment, as well as a charming outdoor deck that extends the living space to the great outdoors, the Oakdale is the epitome of small and compact living done right. This cozy yet functional addition to your property is designed to make the most of every square inch, offering a perfect blend of comfort and versatility.

ENCLOSED	OTHER
20.75m ²	3.18m ²
TOTAL	23.93m²
1	1 1



1800 679 268
 info@i-build.com.au
 www.i-build.com.au

[Facebook@ibuildau](#)
[YouTube@ibuildbuilding](#)
[Pinterest@ibuildbuildings](#)

Eastern Innovation
 5A Hartnett Close
 Mulgrave VIC 3170

© copyright iBuild - v9.17 20220930

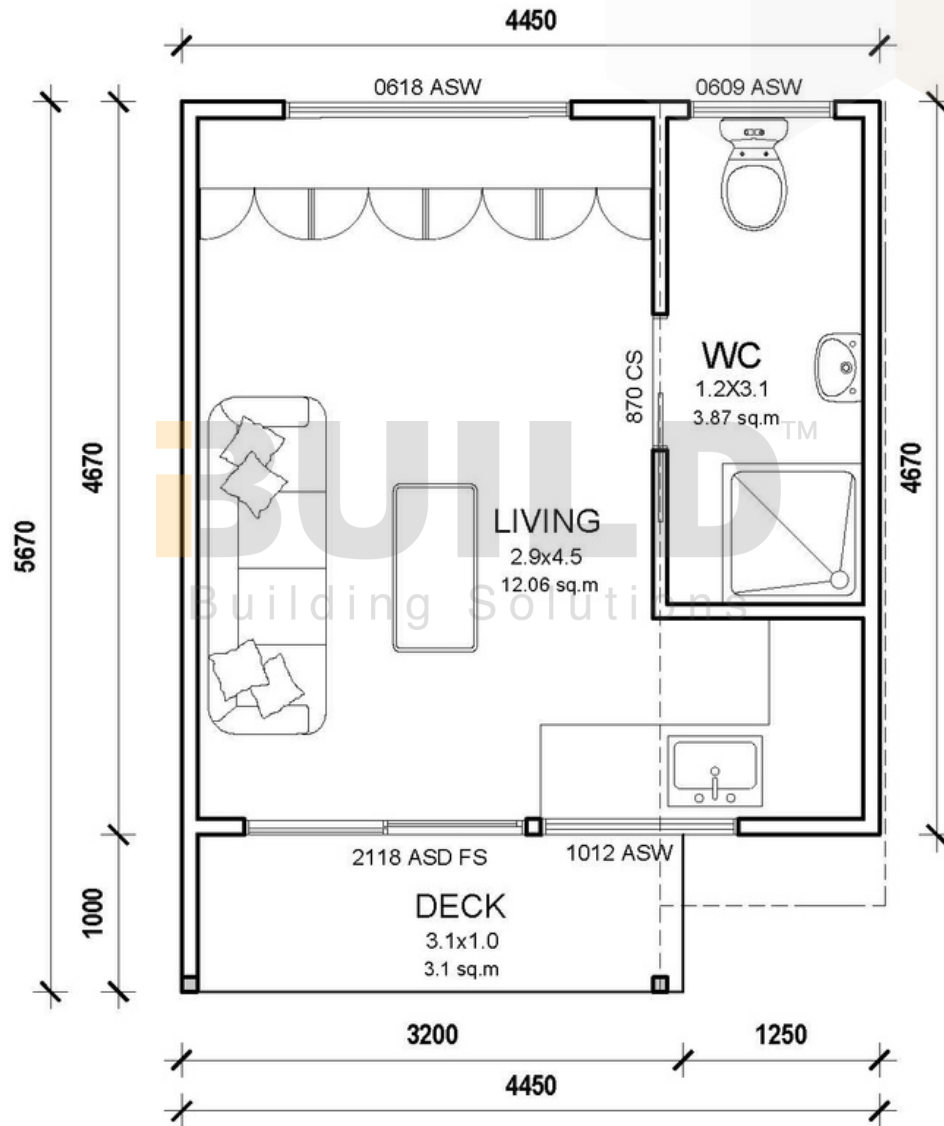

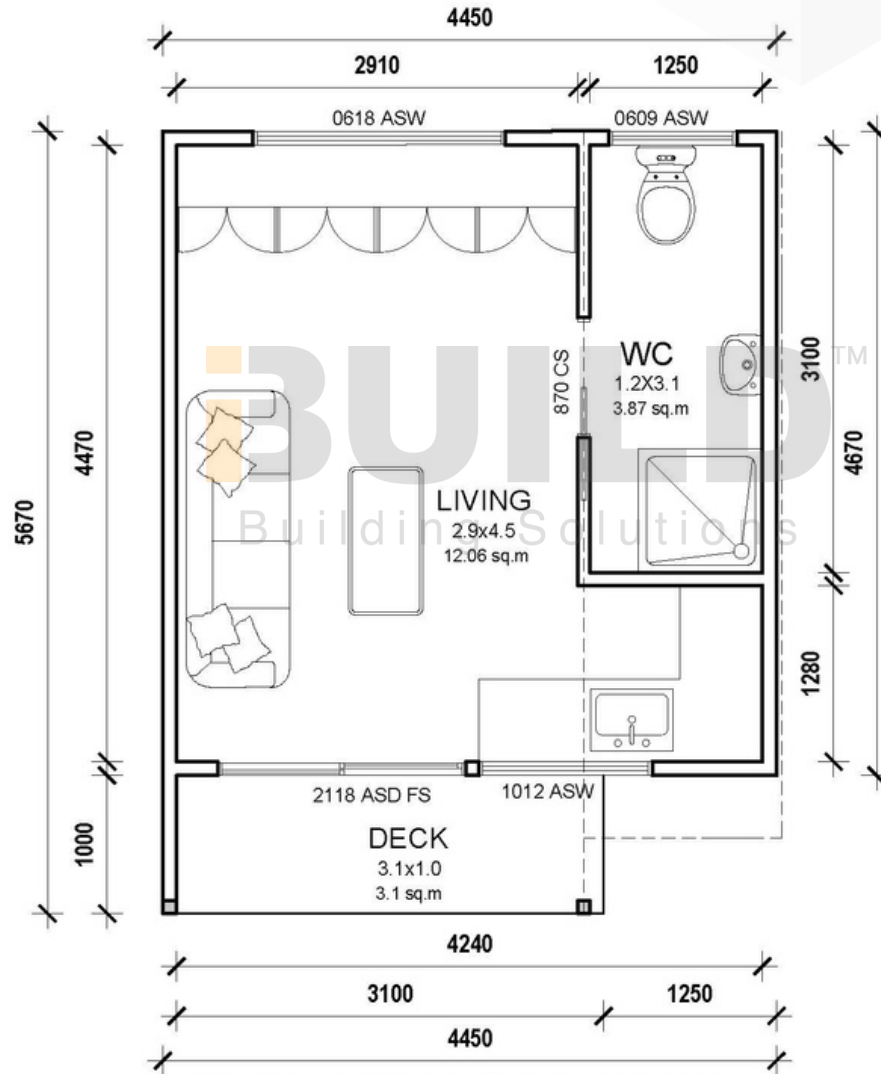



BUILDTM
Building Solutions