





KIT HOMES

ABBHEY VIEW

This two-bedroom, one-bathroom home offers a practical design with comfort in mind. The first floor features an open-plan kitchen and living area, while the ground floor includes two cosy bedrooms, a bathroom, and a laundry. A welcoming deck adds outdoor appeal, making it an excellent choice for families, couples, or as a peaceful retreat.

ENCLOSED 91.06m²	OTHER 12.60m²
TOTAL 103.66m²	
 2  1  1	



59TH AUSTRALIAN
Export & Investment Awards



1800 679 268
info@i-build.com.au
www.i-build.com.au

Facebook@ibuildau
YouTube@ibuildbuilding
Pinterest@ibuildbuildings

Eastern Innovation
5A Hartnett Close
Mulgrave VIC 3170

© copyright iBuild - v9.17 20220930

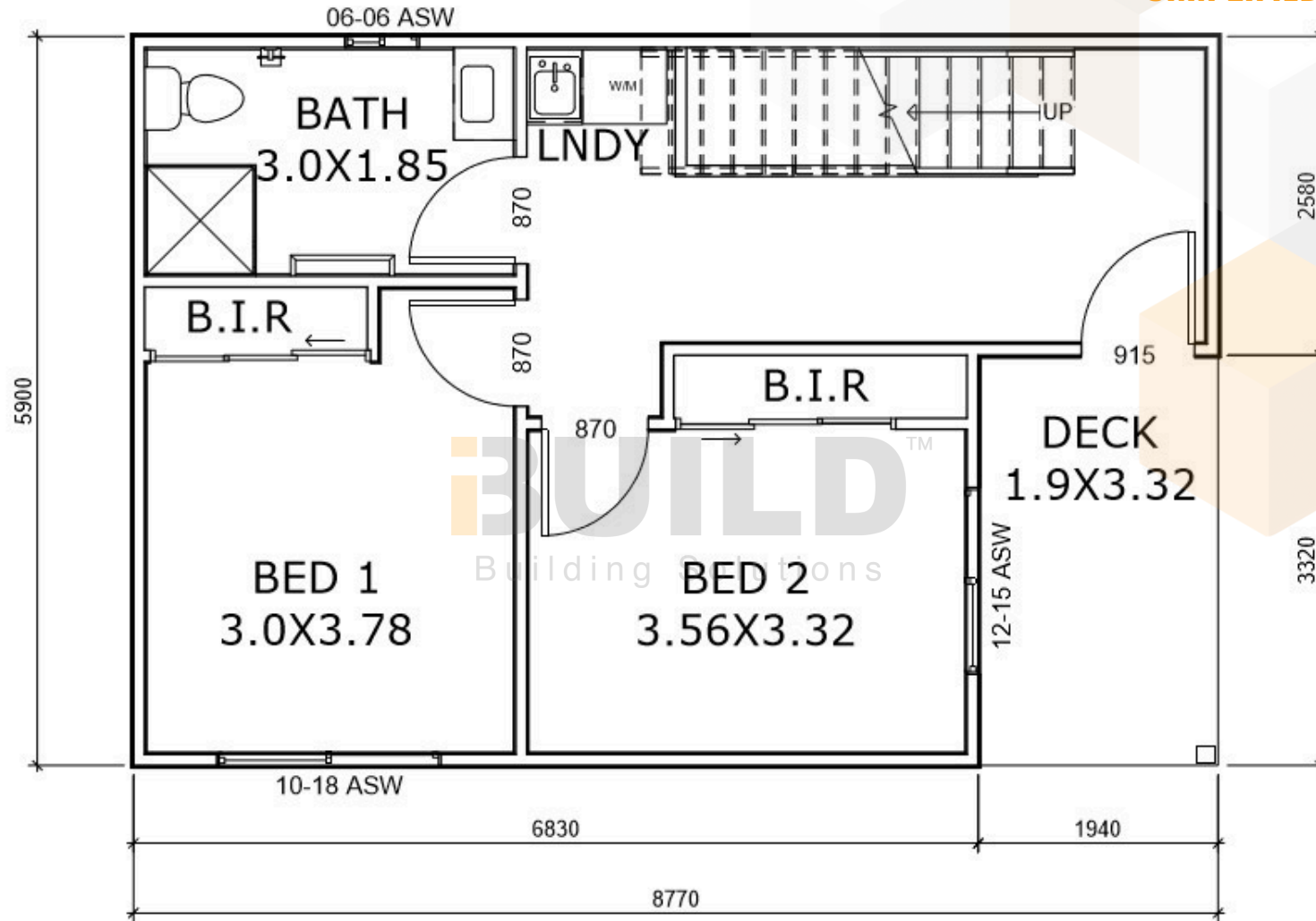

GROUND FLOORPLAN

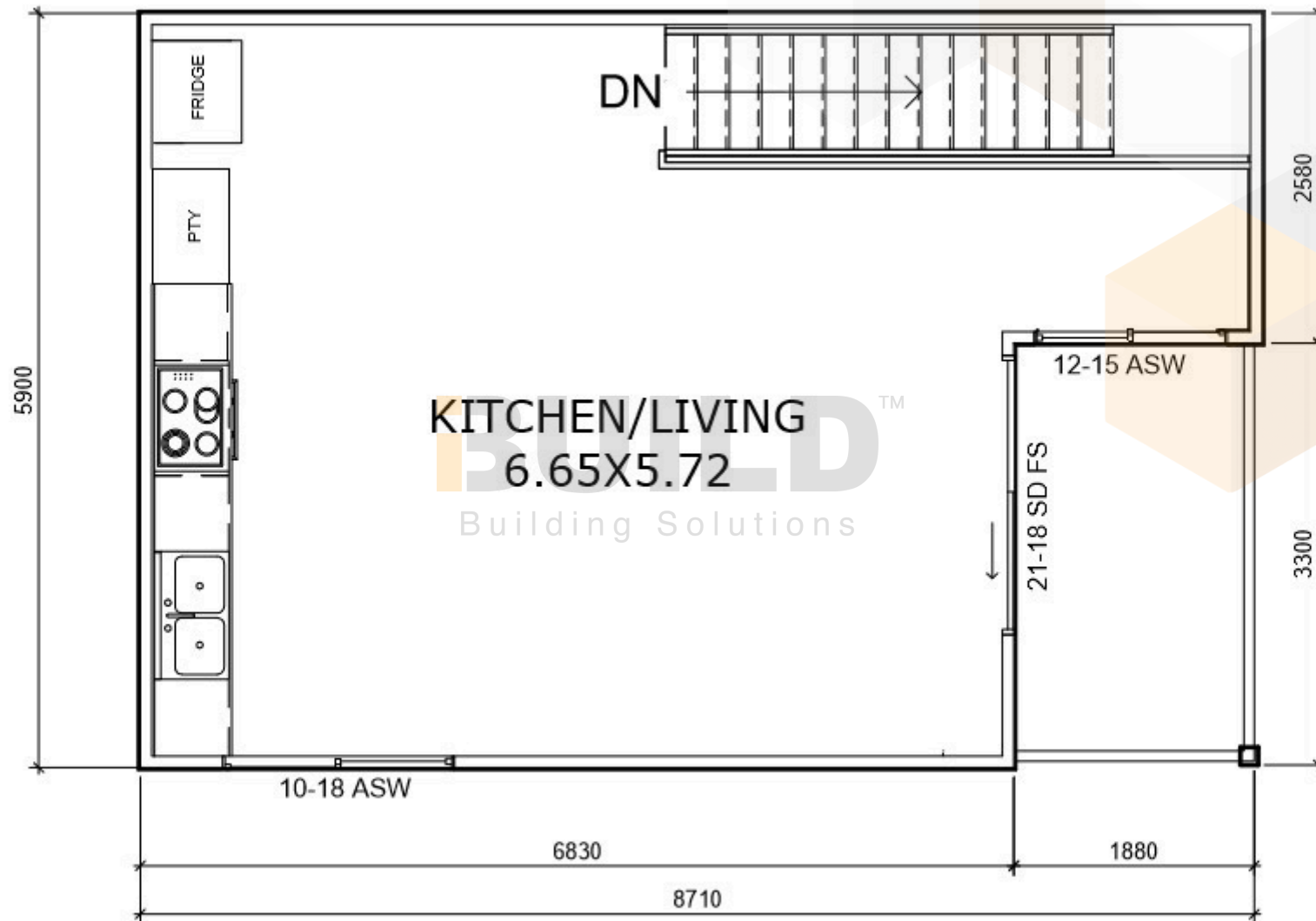

FIRST FLOORPLAN

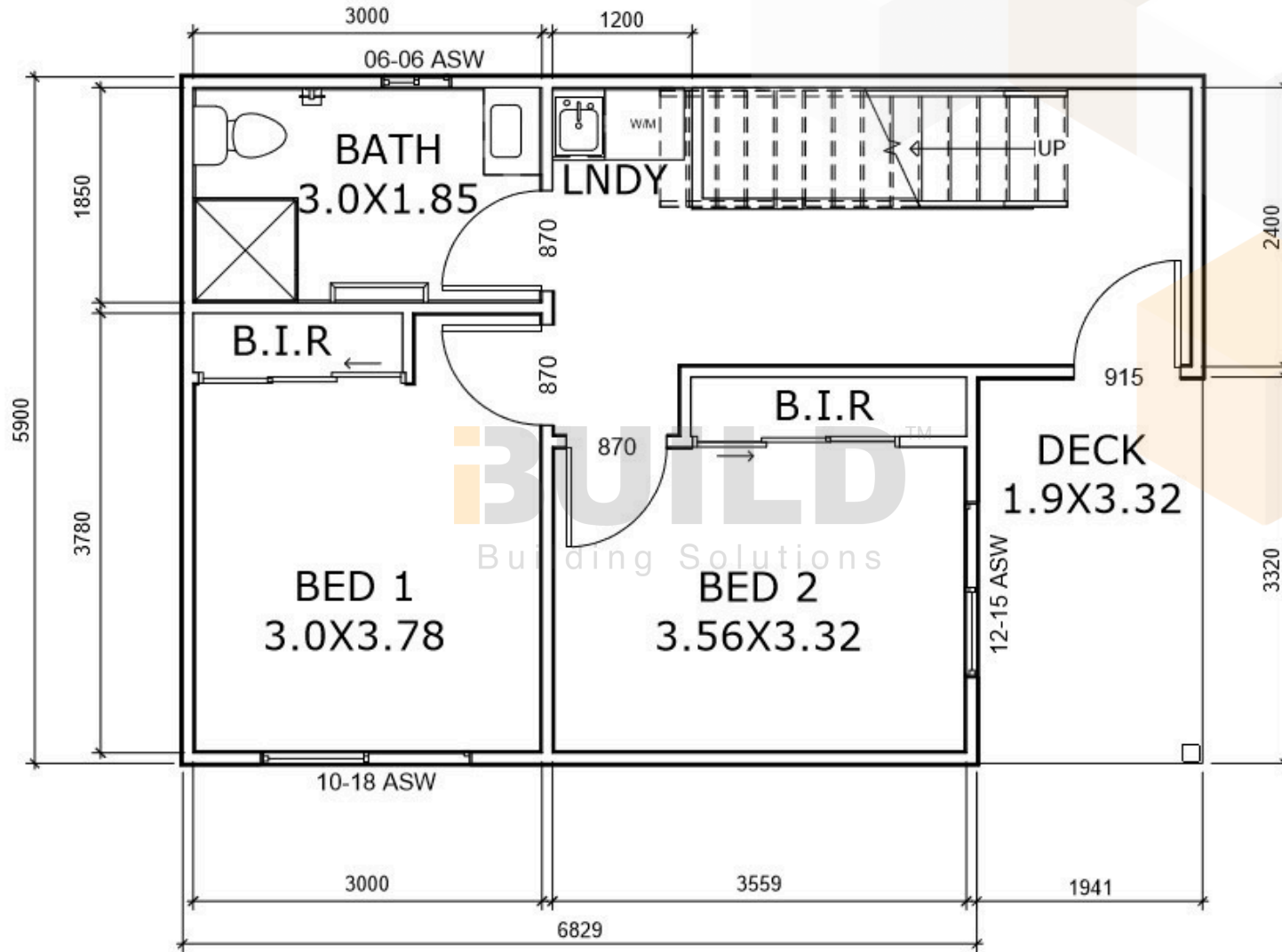

GROUND FLOORPLAN



FIRST FLOORPLAN



